



Descrizione

Connettore IP 68 (per connessioni stagne) basato su GEL silconico bicomponente, predisposto in fabbrica e pertanto pronto all'uso.

Specifiche del prodotto:

- Connettore a 2 uscite
- Connettore per cavi a 2 poli
- Connessione suggerita per cavi di sezione fino a 2 x 0,75 mmq
- Diametro esterno minimo e massimo dei cavi 4,8 – 6 mm
- Ancoraggio cavo (serracavo)- SOLO PER CAVI DIAMETRO ESTERNO 6mm
- Specifiche elettriche 250V 6A
- Certificazione norme EN60998-2-1:2004 Intertek SEMKO
- Morsetti/Morsettiere interni forniti (2 x 2,5 mmq)

Description

IP 68 connector (for waterproof connections) based on two-component silicone GEL, factory-filled and therefore ready to use.

Product Specifications:

- Connection up to 2 ways
- Connector for cables up to 2 poles
- Connector suggested for cables with section up to 2 x 0,75 sqmm
- Minimum and maximum outside diameter of cables 4,8 – 6 mm
- Cable anchorage (cable clamp) – only for external diameter cable 6mm
- Electrical specifications 250V 6A
- Certification standards EN60998-2-1:2004 Intertek SEMKO
- Terminals/Internal terminal blocks supplied (2 x 2,5 sqmm)

Per cavi tondi bipolari 2x0.75mm²: ϕ est. min 4.8 + max 6 *

For round two poles cables 2x0.75mm²: ϕ ext. min 4.8 + max 6 *

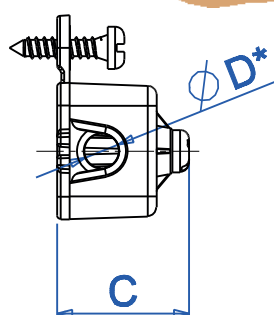
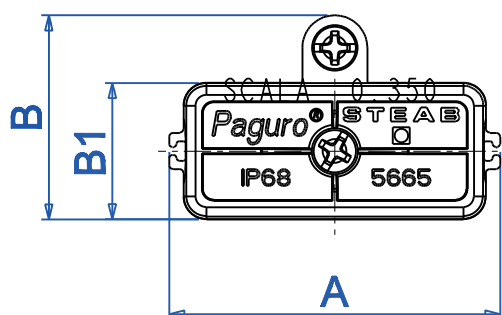
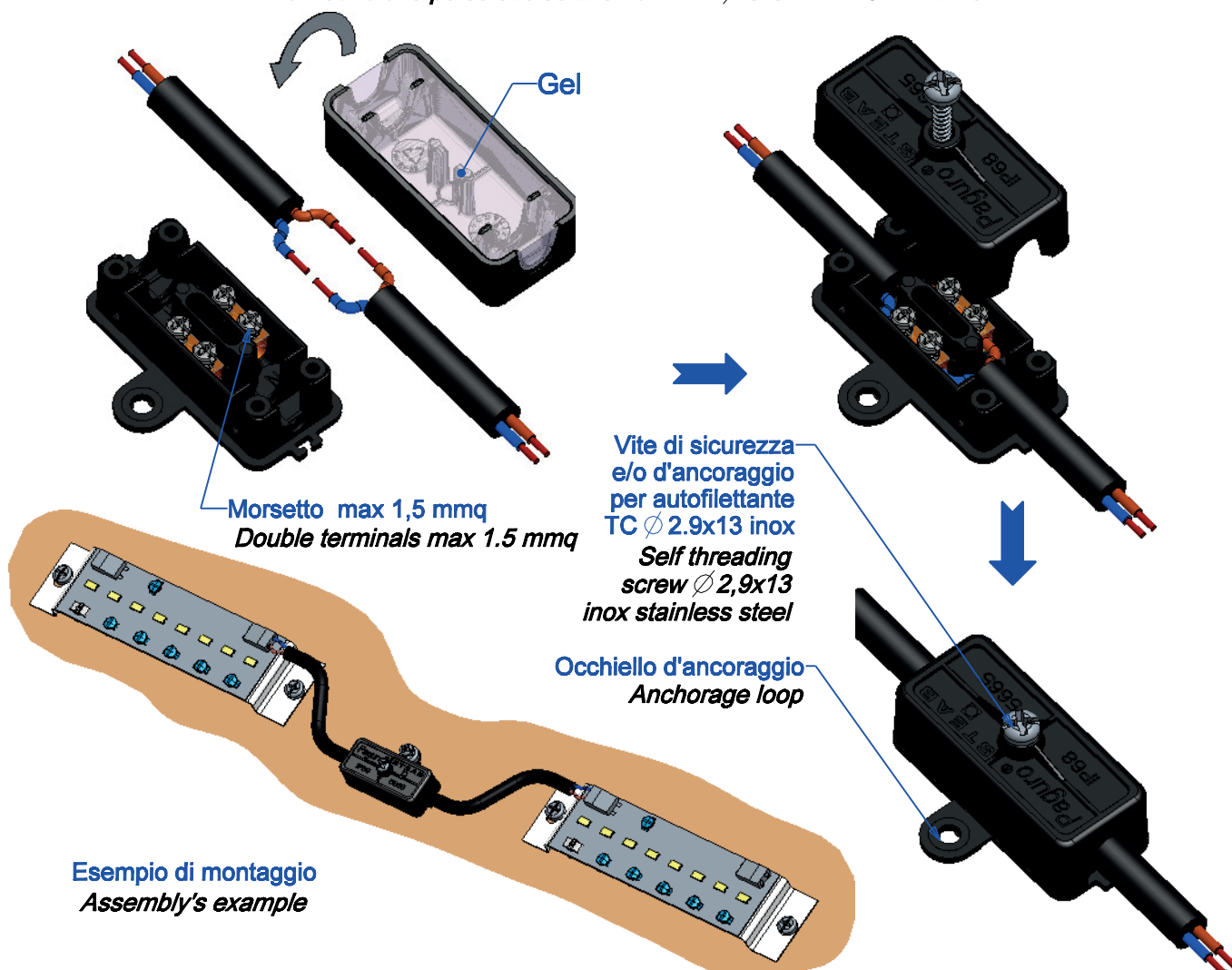

Sguainatura cavi
Wire stripping

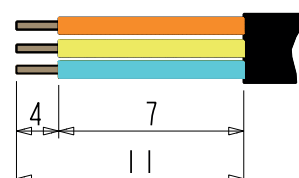

Dimensioni / Dimensions (mm)					Colore/Colour
A	B	B1	C	D	
44	27	18	17.5	*	2 Nero Black
					21

Materiale
Material