

LLD

GOLIA

IP67 IK07 CE   

TIPOLOGIA / TYPOLOGY

Proiettore | Projector

POSIZIONE INSTALLATIVA | INSTALLATION POSITION

A terra, a parete, a soffitto o su pali/alberi

Ground, wall, ceiling or poles/trees mounting

AMBIENTE INSTALLATIVO | INSTALLATION LOCATION

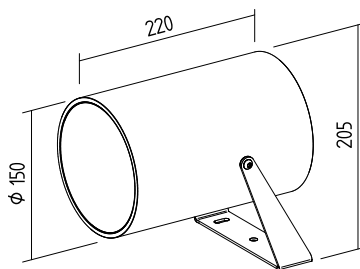
Esterno | Outdoor

GOLIA

51W



kg 4,05

CARATTERISTICHE ELETTRICHE | ELECTRICAL FEATURES

POTENZA ASSORBITA POWER CONSUMPTION	51W
ALIMENTAZIONE POWER SUPPLY	C.C.
ALIMENTATORE POWER SUPPLY UNIT	1400mA non incluso not included
DIMMERAZIONE DIMMING	/
COLLEGAMENTO CONNECTION	Serie Series

CARATTERISTICHE ILLUMINOTECNICHE | LIGHTING FEATURES

COLORE LED LED COLOUR	2700K, 3000K, 4000K
INDICE RESA CROMATICA CRI CRI	>90
OTTICHE OPTICS	11°, 19°, 38°
FLUSSO TOTALE NOMINALE TOTAL NOMINAL LUMENS	5100lm (2700K) 5355lm (3000K) 5865lm (4000K)
DURATA MEDIA LED AVERAGE LED LIFE	50.000h L80 B10

CARATTERISTICHE MECCANICHE | MECHANICAL FEATURES

PESO WEIGHT	Kg 4,05
FINITURE FINISHES	Bianco txt, Grigio txt, Nero txt, Corten, Antracite txt txt White, txt Grey, txt Black, Corten, txt Anthracite
INSTALLAZIONE INSTALLATION	A terra, parete o soffitto con staffa inclusa, a terra con picchetto non incluso, su pali/alberi con cintura di fissaggio non inclusa Floor, wall or ceiling mounting with brackets included, on ground with peg not included, on poles / trees by mounting strap not included
MATERIALE MATERIAL	Corpo in alluminio anticorrosivo verniciato, staffa in acciaio inox verniciato, vetro temperato trasparente serigrafato Varnished anticorrosion aluminium body, varnished stainless steel bracket, silk-screen printed tempered glass

CARATTERISTICHE GENERALI | GENERAL FEATURES

TEMPERATURA DI ESERCIZIO OPERATING TEMPERATURE	-10°C +45°C
GRADO DI PROTEZIONE INGRESS PROTECTION	IP67
GRADO DI RESISTENZA IMPACT RESISTANCE	IK07
GLOW WIRE TEST GLOW WIRE TEST	960°C
TEMPERATURA SCHERMO SCREEN TEMPERATURE	40° @ Ta = 25°
CLASSE DI ISOLAMENTO APPLIANCE CLASS	III
CALPESTABILE WALKOVER	/
CARRABILE DRIVE OVER	/
CAVI DI ALIMENTAZIONE POWER CABLES	Fornito con 50 cm di cavo Provided with 50 cm cable
SICUREZZA STANDARD STANDARD SAFETY	WP System
SICUREZZA FOTOBIOLOGICA PHOTOBIOLOGICAL SAFETY	GR1

GOLIA

ACCESSORI | ACCESSORIES

CODICE / CODE	PL006
TIPOLOGIA / TYPOLOGY	Paralume Shade  kg 0,30
MATERIALE / MATERIAL	Acciaio inox AISI 304 AISI 304 Stainless steel

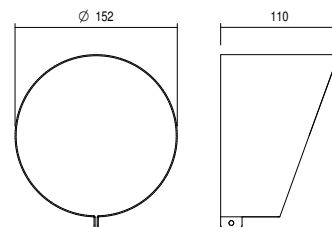

CODICE / CODE	ST017
TIPOLOGIA / TYPOLOGY	Staffa verniciata Varnished bracket  kg 0,28
MATERIALE / MATERIAL	Acciaio inox AISI 316L AISI 316L Stainless steel

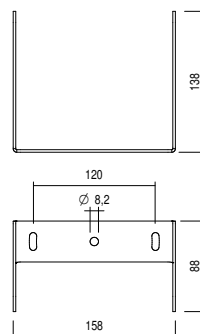

CODICE / CODE	PI002
TIPOLOGIA / TYPOLOGY	Picchetto Peg  kg 0,10
MATERIALE / MATERIAL	Acciaio inox AISI 304 AISI 304 Stainless steel

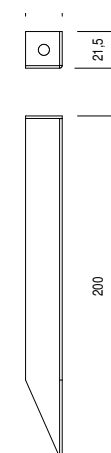

CODICE / CODE	CIN20
TIPOLOGIA / TYPOLOGY	Cinghia di fissaggio Mounting Strap  kg 0,11
MATERIALE / MATERIAL	Nastro in poliestere, fibbia in acciaio zincato, bassetta in AISI 304 Polyester tape, zinc plated steel buckle, AISI 304 base

